

■ Hammer head C-profile 27 M8 x 20 mm

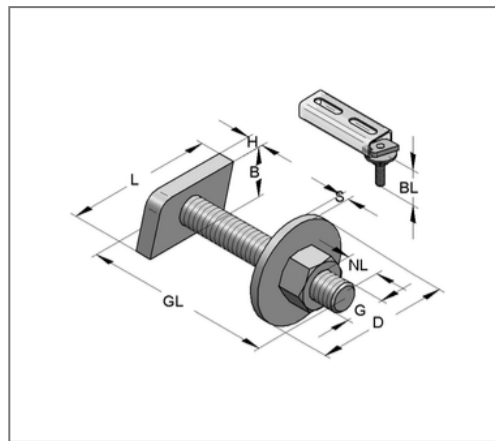
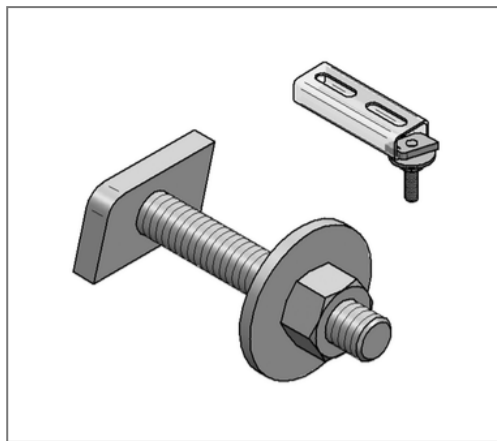

Commercial details

Part no.	0695289
EAN/GTIN	4250928415738
Packing unit	100 pcs
Quantity unit	pcs
Weight	0,0246 kg/pc
Product group	02-069
Price unit	100

QR code



Specification

Application area	Should preferably be used for pipe clamp mounting
Profile type	27
Type of attachment	For glide fast connections and shear hole haunch connections with MEFA profile rails

Technical data

Material	Steel
Material type	S235
Surface	galvanized

Product details

Thread G	M8
Length thread GL	20 mm
Usable length NL	6,3 mm
Overall length BL	15 mm
Length hammer head L	24 mm
Width hammer head H	13 mm
Thickness hammer head H	4 mm
Diameter washer D	25 mm
Thickness washer S	2 mm